









**Special Policy Area 'C'
Lakewood Community
Northern Bruce Peninsula
(Schedule '3')**

Scale 1:8,500

Legend

-  SPECIAL POLICY AREA 5.12.3
-  AGRICULTURAL AREAS
-  RURAL AREAS
-  RURAL RECREATIONAL
-  TRAVEL TRAILER PARK & COMMERCIAL CAMPGROUND
-  INLAND LAKE DEVELOPMENT AREA 5.12.3.1
-  HAZARD LAND AREA 5.12.3.2



0 60 120 240
Metres

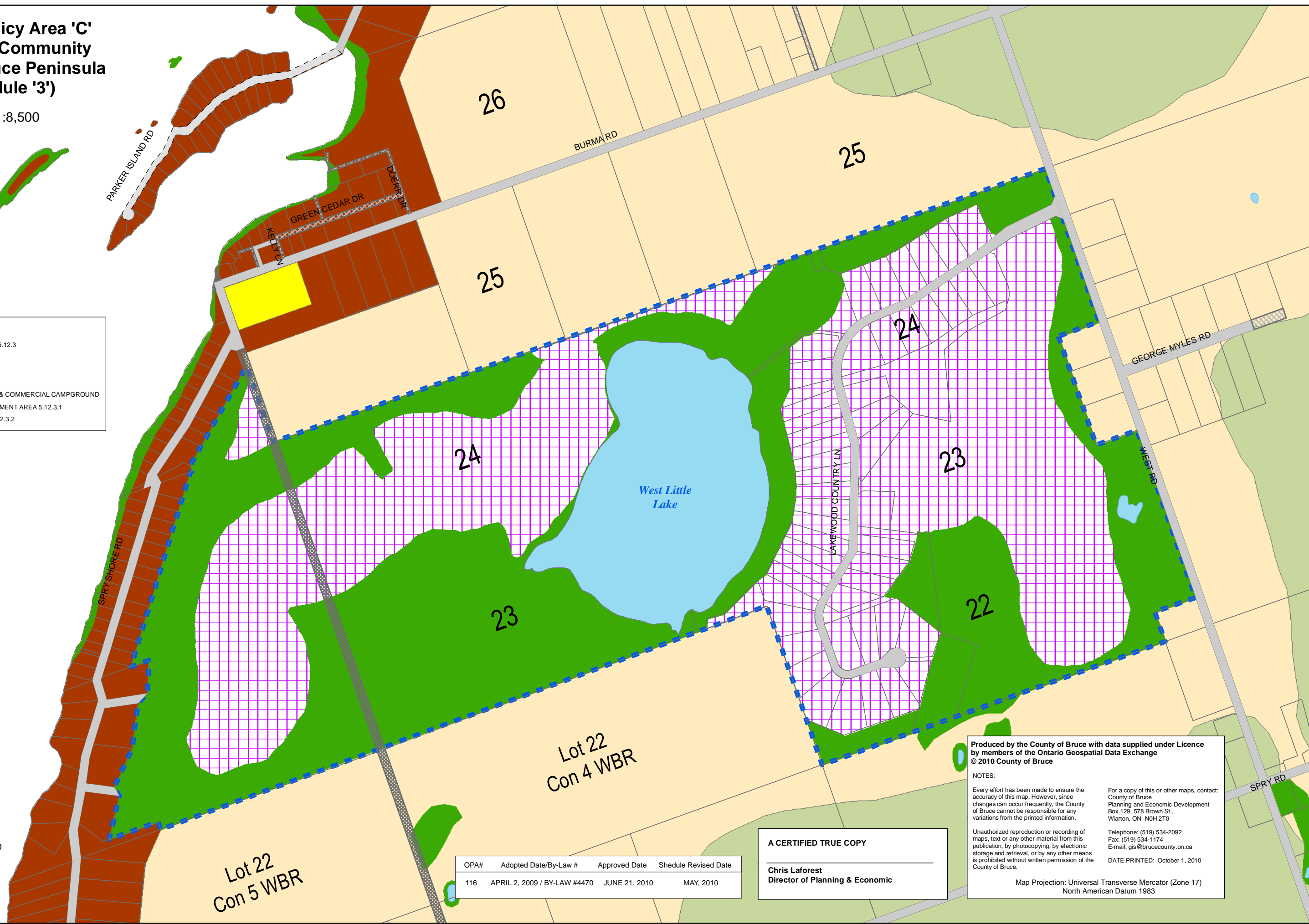

Lot 22
Con 5 WBR

Lot 22
Con 4 WBR

OPA#	Adopted Date/By-Law #	Approved Date	Schedule Revised Date
116	APRIL 2, 2009 / BY-LAW #4470	JUNE 21, 2010	MAY, 2010

A CERTIFIED TRUE COPY

Chris Laforest
Director of Planning & Economic

Produced by the County of Bruce with data supplied under Licence by members of the Ontario Geospatial Data Exchange © 2010 County of Bruce

NOTES:

Every effort has been made to ensure the accuracy of this map. However, since changes can occur frequently, the County of Bruce cannot be responsible for any variations from the printed information.

Unauthorized reproduction or recording of maps, text or any other material from this publication, by photocopying, by electronic storage and retrieval, or by any other means is prohibited without written permission of the County of Bruce.

For a copy of this or other maps, contact:
County of Bruce
Planning and Economic Development
Box 129, 578 Brown St.,
Warton, ON N0H 2T0

Telephone: (519) 534-2092
Fax: (519) 534-1174
E-mail: gis@brucecounty.on.ca

DATE PRINTED: October 1, 2010

Map Projection: Universal Transverse Mercator (Zone 17)
North American Datum 1983